

MOTORIZED KIT

About Us

We appreciate your business!

Congratulations on your new SAWYER product. We are proud to have you as our customer and will strive to provide you with the best service and reliability in the industry. This product is backed by our extensive warranty and world-wide service network. To locate your nearest distributor or service agency, please contact us at the phone number and address listed on the bottom of each page.

You are in good company!

Sawyer Manufacturing Company is the world leader in the design and manufacture of pipeline and welding equipment since 1948. Sawyer equipment has become a standard in the industry and continues to set the benchmark for quality and durability.

This user operation manual has been made to instruct you for the best use and operation of your Sawyer product. Your satisfaction with our products is our main goal. Please read this entire manual carefully noting all tips, notes and warnings. Safety always comes first.



Motorized Kit Manual

Models 206F
For Band Type Beveling
Model 206D

Parts Diagram

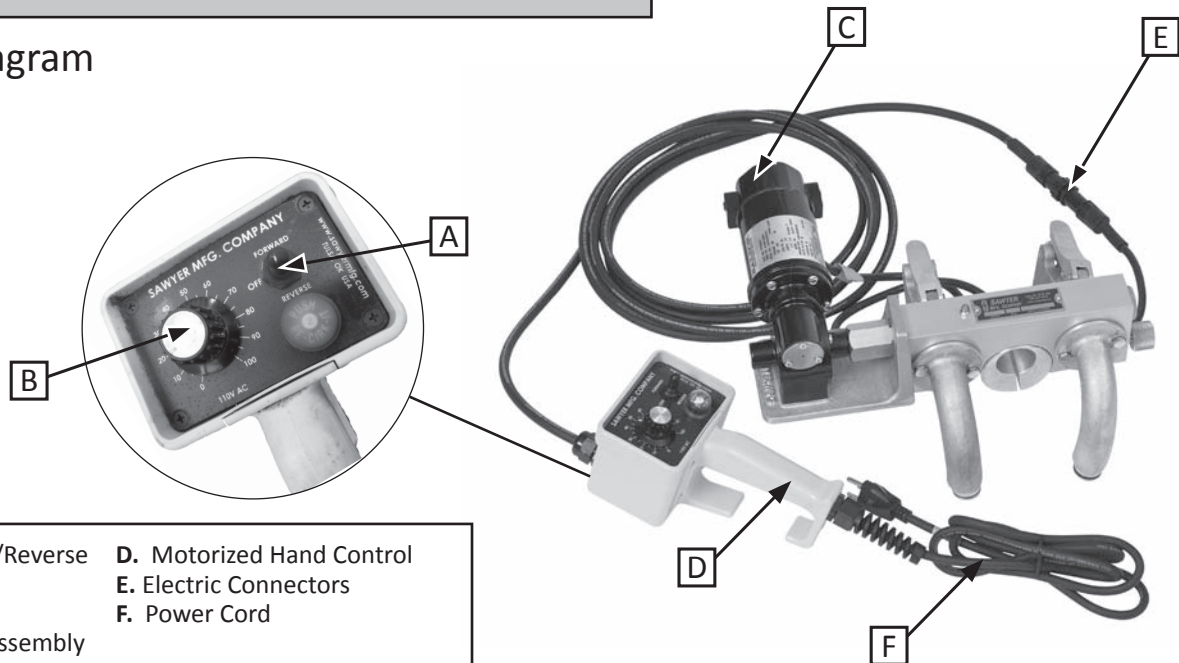

- A. Forward/Brake/Reverse (FBR) Switch
- B. Speed Knob
- C. Baldor Motor Assembly

- D. Motorized Hand Control
- E. Electric Connectors
- F. Power Cord

WARNING

WARNING: Refer to torch manufacturer for safety settings.

WARNING

WARNING: Moving parts can snag and pull. Keep loose items clear.

Warranty

All products manufactured by or for Sawyer Manufacturing Company are guaranteed against defects due to faulty workmanship or materials for twelve months from the date of purchase. This guarantee is limited to the repair or replacement of any parts found to be defective, and no other liability, expressed, implied or contingent is assumed.

Sawyer Manufacturing Company
7799 S. Regency Dr., Tulsa, OK 74131 USA
P 918.834.2550 | F 918.834.0318
sawyerfmfg.com | info@sawyerfmfg.com

V1.2

MOTORIZED KIT

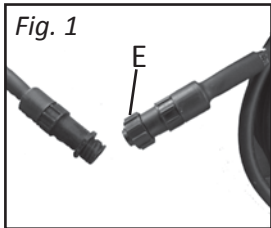

Installation

1. Screw together electric connectors (E, Fig. 1) from Motorized Hand Control (D) and the Baldor electric motor assembly. (C, Fig. 2)
A. Plug power cord (F) into an electric outlet.

Note: The 3 prong male connector inserts into the 3 hole female connector (for 110 AC)

Note: 110 AC and 220 AC options

Note: Position speed to zero and place FBR in neutral before connecting

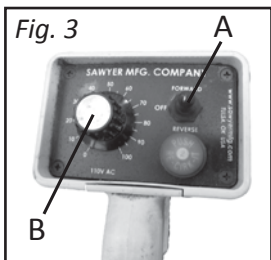
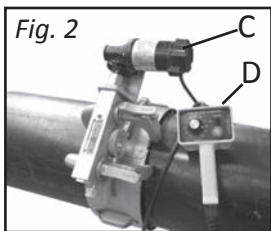

Operation

1. Turn FBR switch (A, Fig. 3) to the forward or reverse position for cutting and/or preheating.

Tip: Preheating is recommended not required.

2. Set the desired speed using the speed control knob. (B, Fig. 3)

Note: uphill and downhill speeds are subject to change

Please refer to the Crawler manual for Operation of the Band Beveling Machine

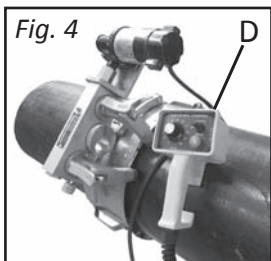

Tip: Motorized Hand Control (D, Fig.4) can be mounted to pipe using magnet on back

Tip: Start with all cords on one side so they don't tangle as the crawler travels around the pipe

Note: Push Re-CIRK-IT is a fuse, not a button

Note: Make sure the FBR Switch (A, Fig. 3) is in the off position before and after use

